

Hesston sales manual

Section 9, Pages 241 - 270

This sales manual from 1976 includes product brochures, pricing and diagrams for individual merchandise sold by the Hesston Corporation. This publication funded by the National Historical Publications and Records Commission through the Kansas State Historical Records Advisory Board.

Creator: Hesston Corporation

Date: 1976

Callnumber: Hesston Public Library

KSHS Identifier: DaRT ID: 448861

Item Identifier: 448861

www.kansasmemory.org/item/448861

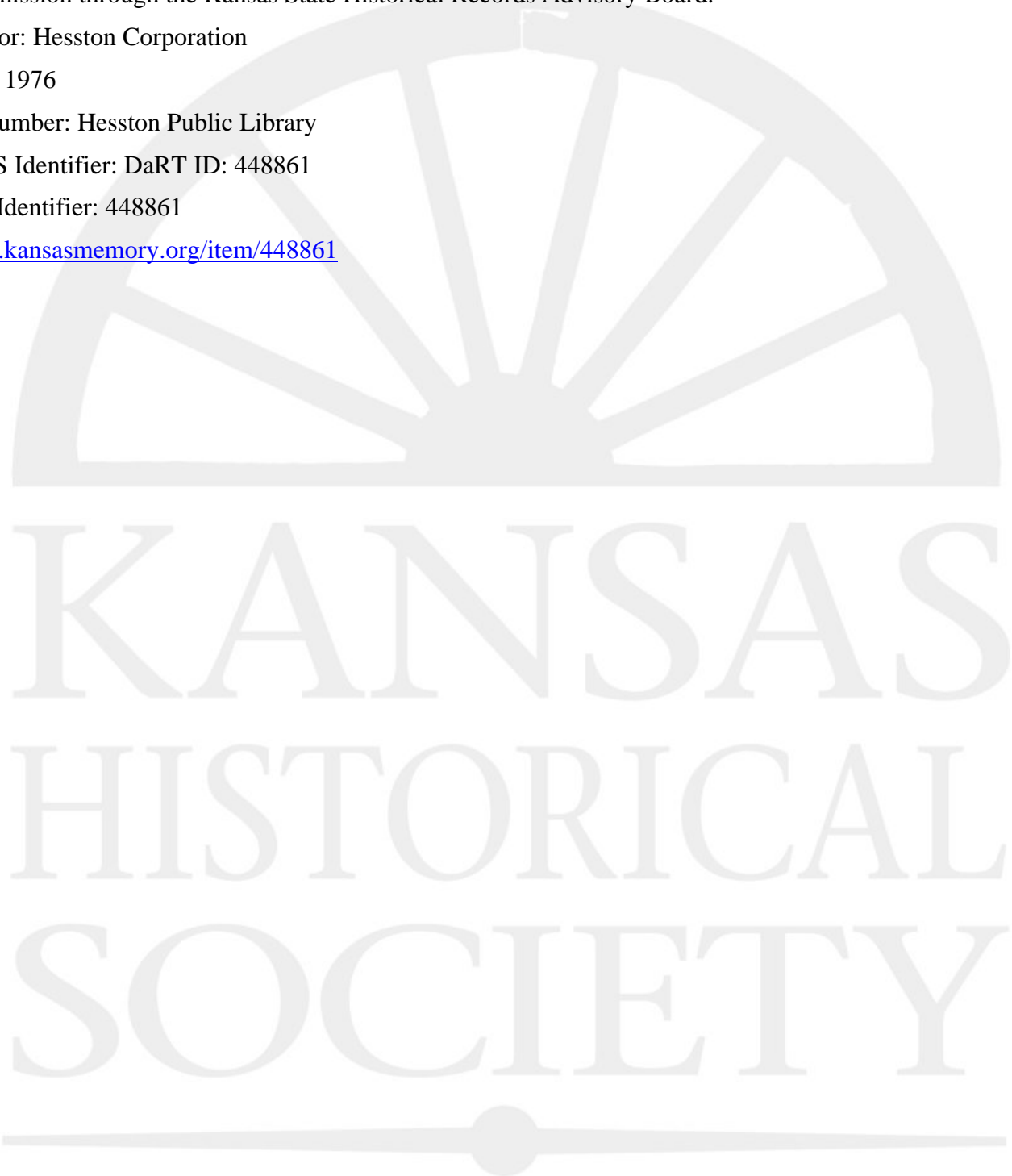



Exclusive fold-down-and-away bulk loader in raised position. Extra high pivot point minimizes incline to prevent roll-back when topping off tall bulk boxes, yet lets all the way down into bottom of box when starting to load.

Digger chain section features rugged, reliable construction throughout: Cast heat-treated full taper cones ride on triple sealed ball bearings to assure free turning. This adds considerably to the life of the digger chain. Chain agitation control is standard equipment and easy to engage or disengage. Depth indicator is standard and blade option includes heavy-duty clod blades, weld-on spoon bill for clod blade (shown) and medium point blade.

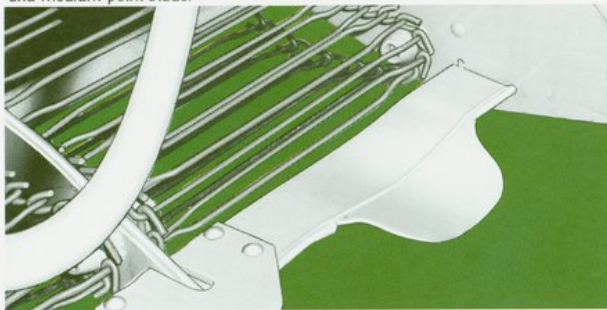

Bulk loader in fold-away position. Overall width with loader folded away is only 14½ feet. This makes roading safer and storing easier.

Bulk loader in extreme lowered position. Three inch flights every tenth link help minimize drop when opening fields without a bulk loading truck.

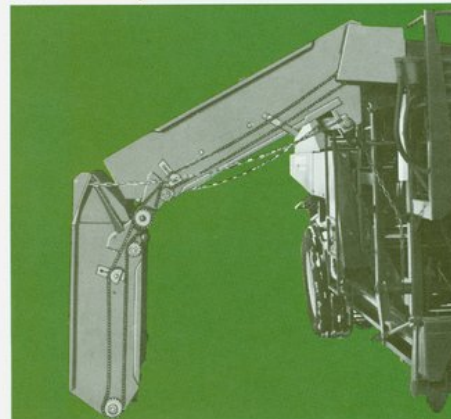

to harvester... everything!

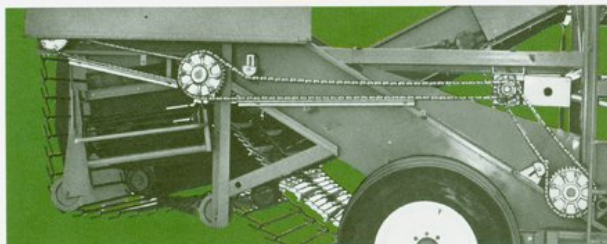

Simple drive train design includes only two gear boxes and heavy-duty driveshafts with interchangeable bearings. Six high-capacity, friction-type slip clutches protect all drives.

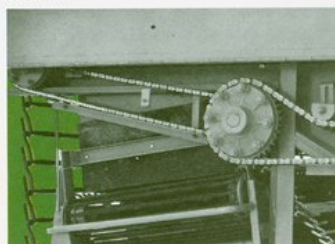

Two standard size chains—RC80 and RC60—feature greater capacity and a smoother operation for longer life. Heavy-duty U-Joints also last longer.



Large 24" diameter notched coulter blades raise and lower automatically with the digger section to prevent breakage when turning. Blade also is moveable to inside or outside of digger wall to prevent trash build-up and to insure proper feeding.

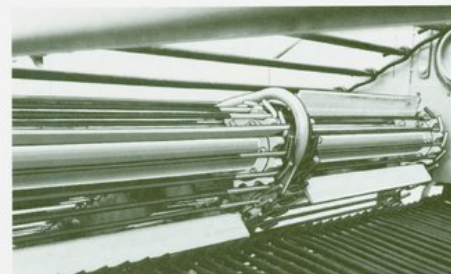

Secondary elevator and digger section driveshafts feature twice the torsional and bending strength of two inch stress-proof steel shafts. Much longer chain life has been proven as a result of this design.

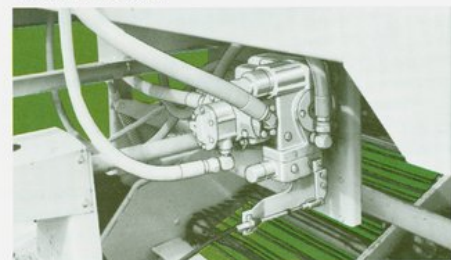

Optional exclusive hydrostatic transmission provides an infinite choice of carrier chain speeds through a single control lever without changing tractor speed. This infinite speed control lets you cover more acres per day than is possible in machines without hydrostatic transmissions. It also helps you get a more bruise-free crop regardless of conditions.

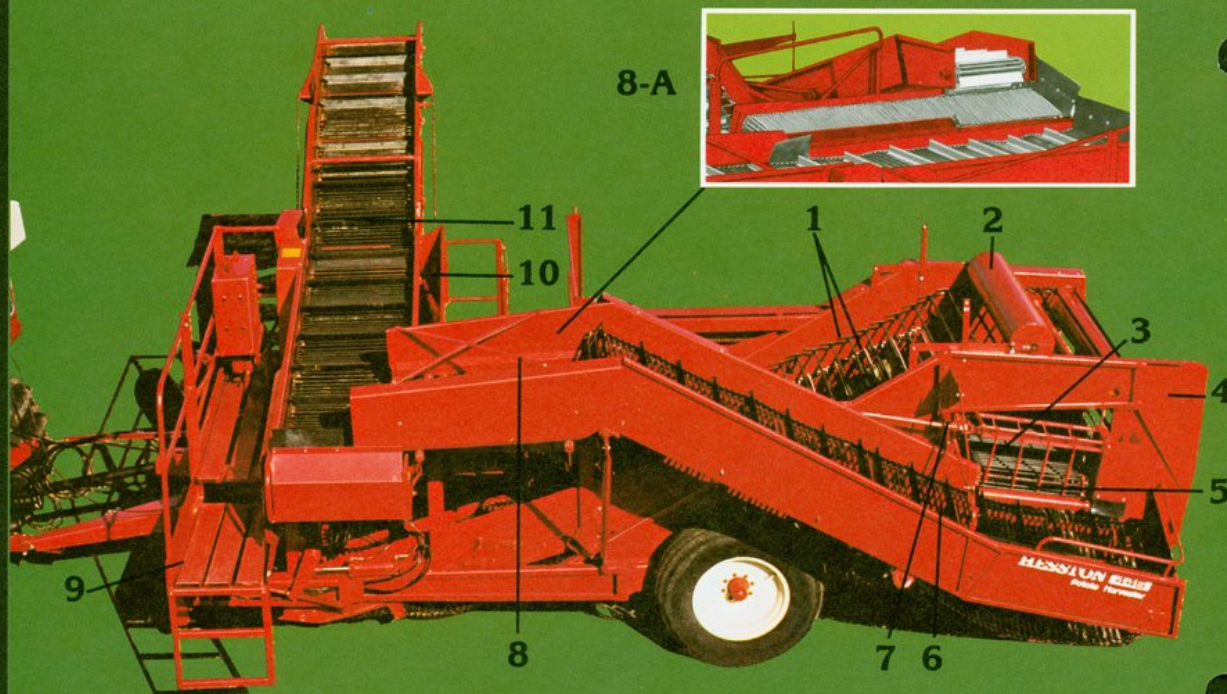

What works best in our harvester we've included in our win

- 1 **De-viner and secondary chains.** The full-width 62" de-viner chain is plastisol coated and has no center hooks to bruise your crop. The secondary chain—just below the de-viner chain—catches the potatoes and carries them to the rear cross table. Two-inch flights are properly angled when at the top of the secondary chain to prevent "throwing" the crop onto the cross table. Other "crop protectors" in the secondary chain include optional pitches, straight links and a choice of plastisol or flexedge coatings. The reason straight links are used on all chains beyond the digger section is to prevent pinching and potato loss. Flexedge coating on links with thin flights allows flexing of the flights to rid the link of mud.
- 2 **Exclusive 12" stripper roll** holds potatoes that cling to the vines down until they are stripped from the vine and fall onto the rear cross table. The big diameter and exceptional flotation of the stripper prevent plug-ups at this point.
- 3 **Rear cross table** is 33" wide and features adjustable tilt, optional pitches and coating, and three-point suspension. This suspension—made possible by the ball-and-socket joint side elevator suspension—plus a cantilever de-viner roll design prevents trash build-up at the front inside corner of the cross table. Stripper guard prevents trash build-up on idler roller.
- 4 **Wind shield** at rear of de-viner roll helps prevent blowing of trash onto un-dug rows.
- 5 **Power driven de-viner roll** and spring-loaded fingers work together to eject trash onto ground.
- 6 **33" wide side elevator** tilts easily to allow maximum potato/clod separation.
- 7 **Standard 1 1/4" size driveshafts** for all conveyors—rear, side and front—prevent both flexing and twisting. As a result, they help prevent crooked chain wear and add significantly to the life of these expensive replacement items. Anti-wrap sleeves are also a feature on all driveshafts.
- 8 **Optional dirt/clod roller table** features fluted rubber rollers that adjust to fit soil conditions. (Recommended where clods are limited and moist, humus soils are hard to shake through the chain conveyors.) Long extension (with same chain as that used in the side elevator) is recommended (though not shown) where trash is no problem.

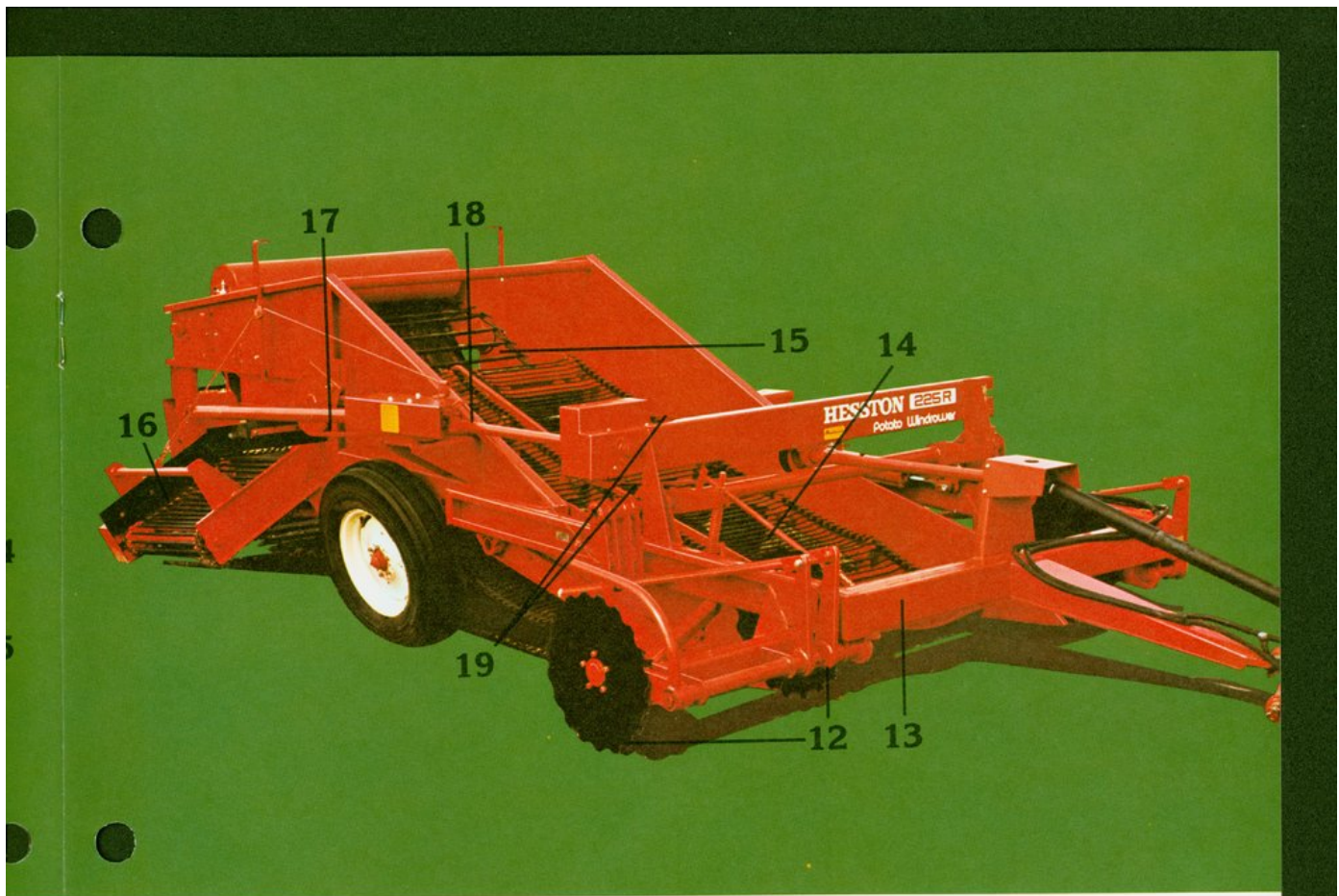

our windrower. So both have many interchangeable parts!

- 8a Standard adjustable tilt table is used with short extension from side elevator and recommended where there are excessive clods, rocks and green materials. Extension adjusts with tilt table to assure a constant minimum drop.
- 9 Worker's platforms at front and rear of unit lend themselves to light or heavy sorting chores.
- 10 Optional trash chutes—front and/or rear—let workers conveniently pick towards themselves. Trash and clods are conveyed onto harvested ground.
- 11 Continuous 31" front cross table/bulk loader conveyor eliminates one drop and assures more gentle conveyance of potatoes to the bulk box.
- 12 24" notched coulters are the same as those used on the harvester and raise or lower automatically with digger section. Optional windrower coulters end the problem of vines spreading from row to row.
- 13 Frame members are massive—the same as those in the harvester. Side members and other structural features are also similar to the harvester's construction.
- 14 Digger chain section is the same as that in the harvester except the windrower chain is longer. This extra length gets the crop cleaner and increases the harvester's efficiency. Depth indicator same as harvester's, too.
- 15 De-viner chain is also the same as harvester's except that it's shorter. Travel design and stripper roll position assures excellent potato/vine separation.
- 16 Rear cross table—which is also the delivery section—has the same chain as the harvester with more links. Same stripper guard on idler end of table, too.
- 17 RC80 chain drives digger section and is interchangeable with harvester's RC80 chain.
- 18 Driveshafts on the 225 are also the same quality as those on the harvester. So they, too, add to the life of the chains.
- 19 Triple groove power band belt drives input shaft. A double groove belt here would have proved sufficient. Hesston, however, wanted more than enough capacity. The result is a power band belt strong enough to also serve as an overall slip clutch. Belt and other drives run exceptionally quiet.



Double—even triple—your harvesting capacity! Here's how:

Hesston's 225 windrower is designed to let you take full advantage of the 445 harvester's big capacity. And even add to that capacity.

It adds to the harvester's capacity by giving potatoes an initial cleaning. And it lets you take full advantage of all this capacity by digging two rows and placing them between two adjacent rows (to double the harvester's capacity) or, when conditions permit, digging two more rows on the opposite side of the undug rows and placing them on the first two rows. In other words, you can dig a total of four rows with the windrower and place them between two undug rows. Then the harvester can dig and pick up a total of six rows in one trip through the field.

You have to see the harvester working at this capacity to really appreciate both it and the windrower. Once you do, you'll never settle for less than the whole system.

Like the harvester, the 225 windrower is built rugged to take any adverse condition in stride. At the same time, your initial investment is only slightly more than one third that of a harvester.

But above all, the 225 saves you valuable time. When truck trips and harvester trips are considered, your harvesting time is cut at least 50% by using a 225 windrower. So do yourself a big favor, check out both the 225 windrower and 445 harvester before you buy any harvesting system.

Compare features! No other windrower measures up!

Rear cross table/delivery section is hinged and automatically raises and lowers with the digger section. This feature lets you avoid putting potatoes in a pile at the end of the turnrow. Instead, just raise the digger section and back up slowly as machine is running. This distributes the potatoes left in the machine on the windrowed potatoes. And because the table raises with the digger, you don't gouge those potatoes already in the row. (Left or right hand delivery is optional.)

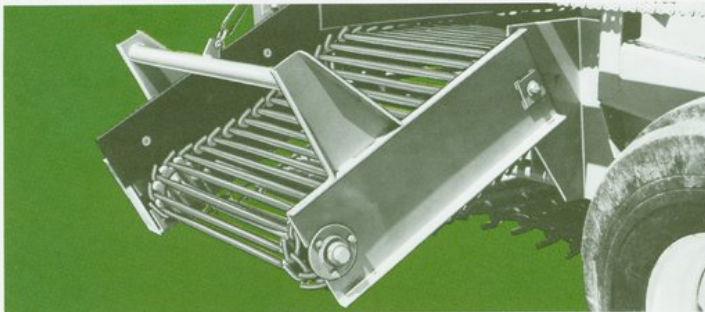

100 hp gear box exceeds requirements. And only one gear box is needed for the whole machine!

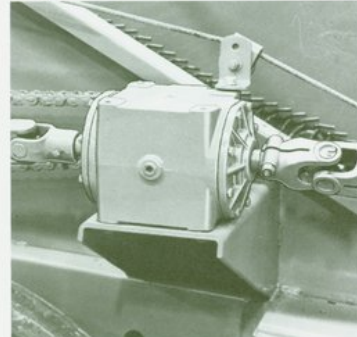

Stripper roll at rear of de-viner chain is the same big 12" size as that used on the harvester. Large diameter and flotation prevents plug-ups.

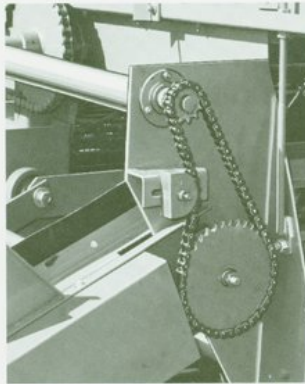

Driveshaft drives rear cross table/delivery section from back side. This design gets drive out of the way of trash.

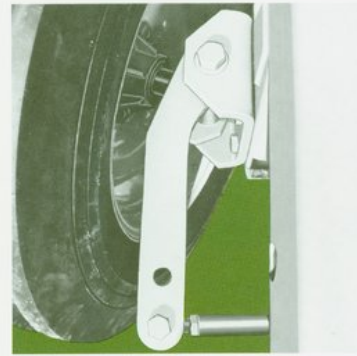

Optional power steering kit (34" minimum row spacings) is easy to install. Just take out four bolts, remove non-steer stub and put in power steer stub along with a steering rod and cylinder.

SPECIFICATIONS — HESSTON HARVESTER & WINDROWER

Specifications subject to change without notice. Prices subject to change without notice.

445 Harvester:

Description—2-row, open throat pull-type harvester with PTO drive
Row spacing—32" to 40"
Tractor requirements—80 hp PTO minimum
Tractor PTO—1000 rpm standard (540 available)
Tractor hydraulic system—up to 2500 psi
Approx. weight (less hydrostatic transmission)—12,000 lbs.
Approx. weight (with hydrostatic transmission)—12,500 lbs.
Approx. weight on hitch—1,800 lbs.
Overall length (with deflector shield)—26 feet
Overall width (bulk loader folded away)—14½ feet
Overall width (bulk loader extended)—21½ feet
Overall height (bulk loader lowered)—9 feet
Height of bulk loader (inner pivot point to ground)—94 inches
Tires—11.25 x 24 eight ply implement
Hitch—quick detach ball and pin
Coulters kit (factory installed)—179 lbs.
OPTIONAL EXTRAS
Dirt/clod roller table with fluted rubber rolls.
Trash chutes—front and/or rear
21.5 x 16.1 six ply flotation tires—available for 4-row tread axle only
Exclusive hydrostatic transmission—provides a choice of infinite carrier chain speeds through a single lever control without changing tractor speed
2-row tread—power steering for sidehill drift
4-row tread axle with power steering and safety platform—provides stability where steep sidehills are a problem

225 Windrower:

Approx. weight (less extra equipment)—4520 lbs.
Approx. weight on hitch—220 lbs.
Overall length (with deflector shield)—23'4"
Overall width—11'
Row spacing—32" to 40"
Tires—9.50-20, 6 ply (35 psi)
Tractor PTO—1000 rpm standard (540 available)
Tractor PTO horsepower requirement—40 to 60
Tractor hydraulic system pressures—up to 2500 psi
Operating speeds—1 to 4 mph
Hitch—quick detach ball and pin
De-viner chain—5.75 pitch standard
Coulters kit (factory installed)—179 lbs.
Rear cross conveyor chain (plastisol covered)—1.76 pitch

EXTRA EQUIPMENT

540 rpm PTO kit (field installed)—50 lbs.
Windrow coulters kit (left or right hand, field installed)—178 lbs.

OPTIONAL EQUIPMENT

Basic option: Right hand delivery
Left hand delivery
Axle option: Stub axle
Power steering axle (36" to 38" row)
Digger lift cylinder kit: Available thru Parts Dept.

OPTIONAL EQUIPMENT — HARVESTER & WINDROWER

| | |
|--|--|
| Digger blades: Medium point blade | Digger chain: 1.56 pitch (1 up, 1 down) |
| Heavy duty clod blade (32" to 34" row spacing) | 1.56 pitch (all down)—harvester only |
| Heavy duty clod blade (36" to 38" row spacing) | 1.76 pitch (1 up, 1 down)—windrower only |
| Weld-on replaceable point for clod blades (available thru Parts Dept.) | 1.76 pitch (all down) |
| | 2.00 pitch (all down) |

Hesston Potato Windrower Model 225

First with a better way.



445 POTATO HARVESTER EXTRA EQUIPMENT

Whole Goods
Order Number

B-1 MEDIUM POINT BLADE

Recommended in sandy soil.

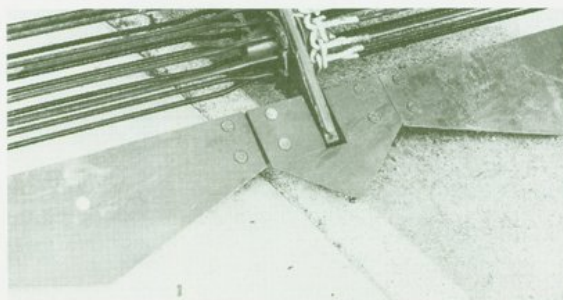

B-2 STANDARD CLOD BLADE

Recommended in heavy, sticky black soil - minimum rocks.



B-3 HEAVY DUTY CLOD BLADE

Recommended in heavy clod soil.

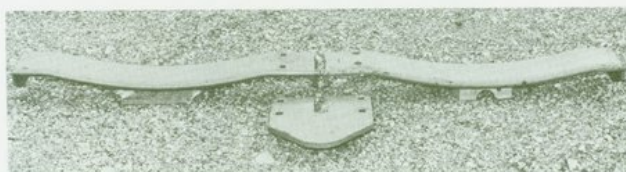

6307797 CLOD BLADE POINT (Available through parts department)

Recommended where potatoes are set deep. Also where it is advantageous to take less soil onto the digger section.



445 POTATO HARVESTER EXTRA EQUIPMENT

Whole Goods
Order Number

B-1 MEDIUM POINT BLADE

Recommended in sandy soil.



B-2 STANDARD CLOD BLADE

Recommended in heavy, sticky black soil - minimum rocks.



B-3 HEAVY DUTY CLOD BLADE

Recommended in heavy clod soil.

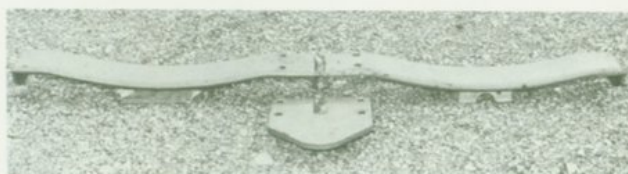

6307797 CLOD BLADE POINT (Available through parts department)

Recommended where potatoes are set deep. Also where it is advantageous to take less soil onto the digger section.



445 POTATO HARVESTER EXTRA EQUIPMENT

Whole Goods
Order Number

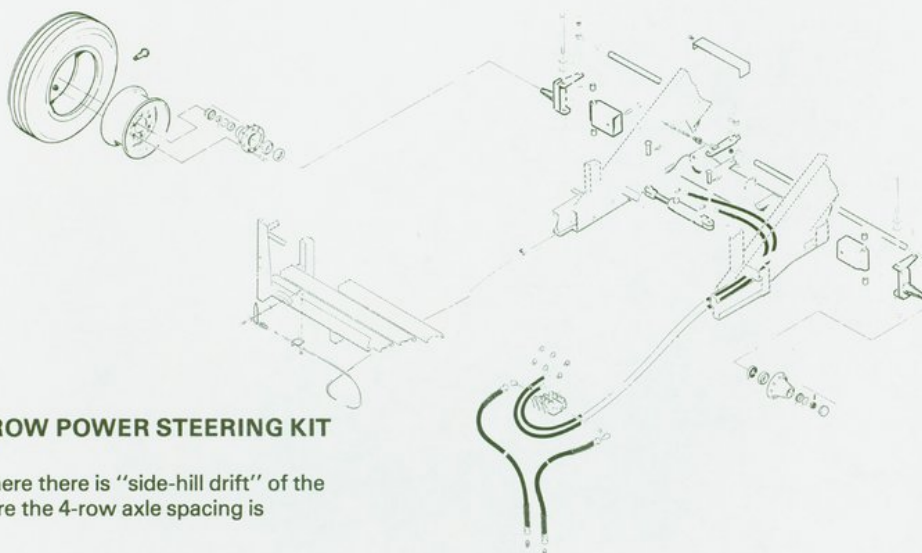

4615 TWO ROW POWER STEERING KIT

Recommended where there is "side-hill drift" of the harvester and where the 4-row axle spacing is undesirable.

4616 FOUR ROW AXLE AND POWER STEERING KIT

For harvester stability, turning assistance on short head lands, and side hill drift.

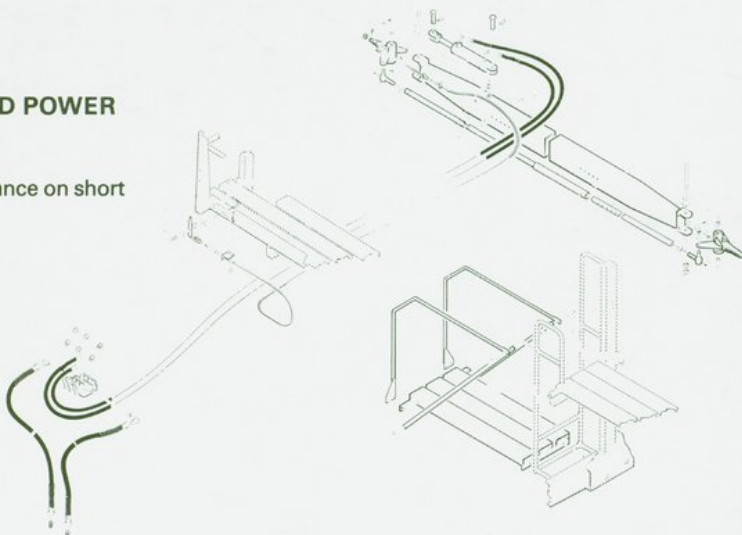

445 POTATO HARVESTER EXTRA EQUIPMENT

Whole Goods
Order Number

4617 FLOTATION TIRE KIT (Can be used with 4616 only)

For extremely loose soil conditions, such as muck or peat moss-type soils where flotation is a problem. Minimum row spacing is 36".

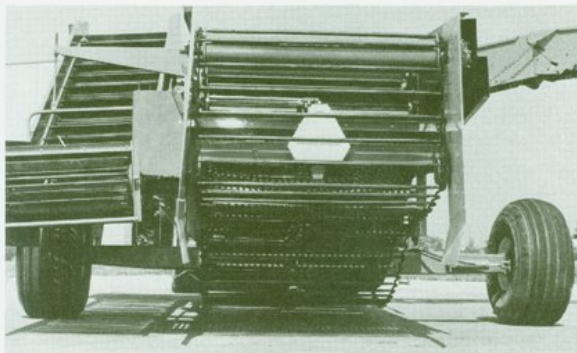

4618 540 RPM PTO KIT

Must be ordered if harvester is to be used with a tractor equipped with 540 rpm PTO only.

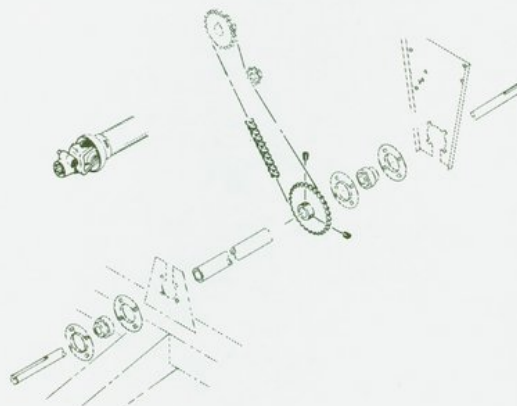

445 POTATO HARVESTER EXTRA EQUIPMENT

Whole Goods
Order Number

4617 FLOTATION TIRE KIT (Can be used with 4616 only)

For extremely loose soil conditions, such as muck or peat moss-type soils where flotation is a problem. Minimum row spacing is 36".

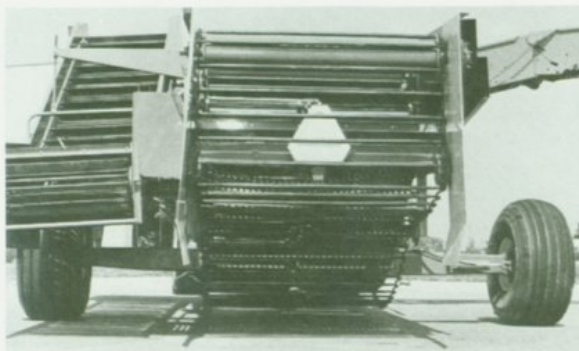

4618 540 RPM PTO KIT

Must be ordered if harvester is to be used with a tractor equipped with 540 rpm PTO only.

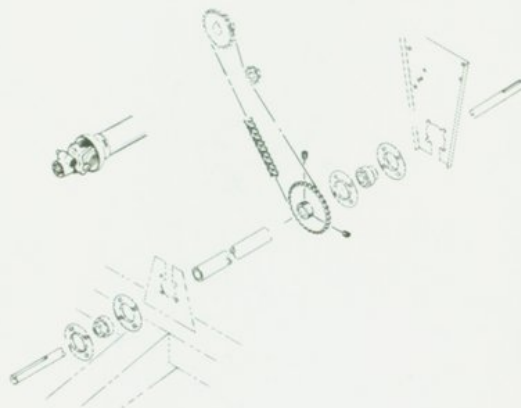

445 POTATO HARVESTER EXTRA EQUIPMENT

Whole Goods
Order Number

965582 12" DIAMETER STRIPPER ROLL KIT

For harvesting potatoes when vines are green and potatoes cling to vines.

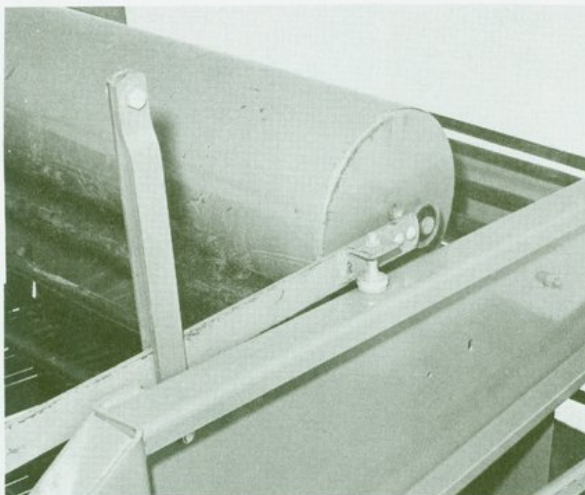

4612-13-14 TRASH CONVEYOR KIT

For rocky and/or clod conditions. Use 4612 front trash kit only with C-1 and C-2. Use 4612 and/or 4613 with C-3 and C-4.

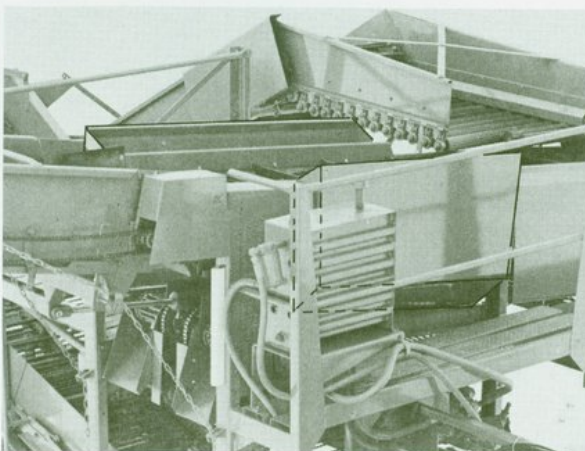

961987 BULK LOADER HOLDDOWN ROLLERS

Recommended if bulk loader is to be operated in its fully raised position.



445 POTATO HARVESTER EXTRA EQUIPMENT

Whole Goods
Order Number

965582 12" DIAMETER STRIPPER ROLL KIT

For harvesting potatoes when vines are green and potatoes cling to vines.

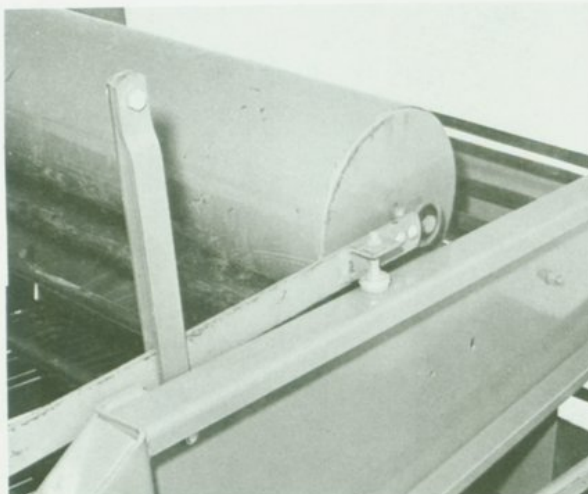

4612-13-14 TRASH CONVEYOR KIT

For rocky and/or clod conditions. Use 4612 front trash kit only with C-1 and C-2. Use 4612 and/or 4613 with C-3 and C-4.

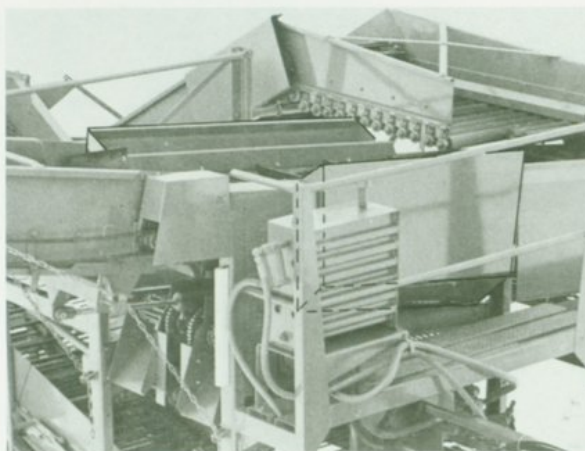

961987 BULK LOADER HOLDDOWN ROLLERS

Recommended if bulk loader is to be operated in its fully raised position.

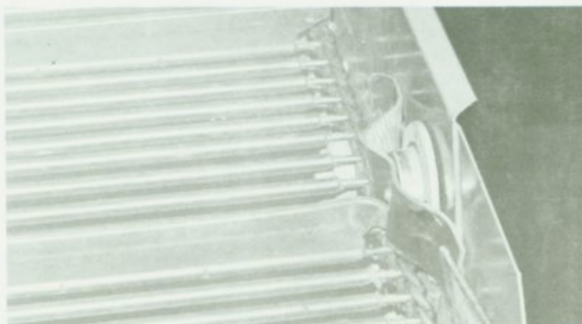

225 POTATO WINDROWER EXTRA EQUIPMENT

Whole Goods
Order Number

4705 540 RPM PTO KIT

Must be ordered if windrower is to be used with a tractor equipped with 540 rpm PTO only.

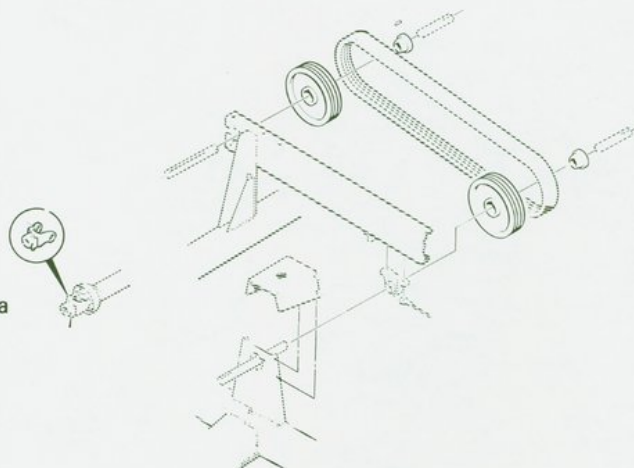

965723 DIGGER LIFT KIT

Order when extra lift cylinder and hoses are not available and when it is desired that cylinder remain with windrower.

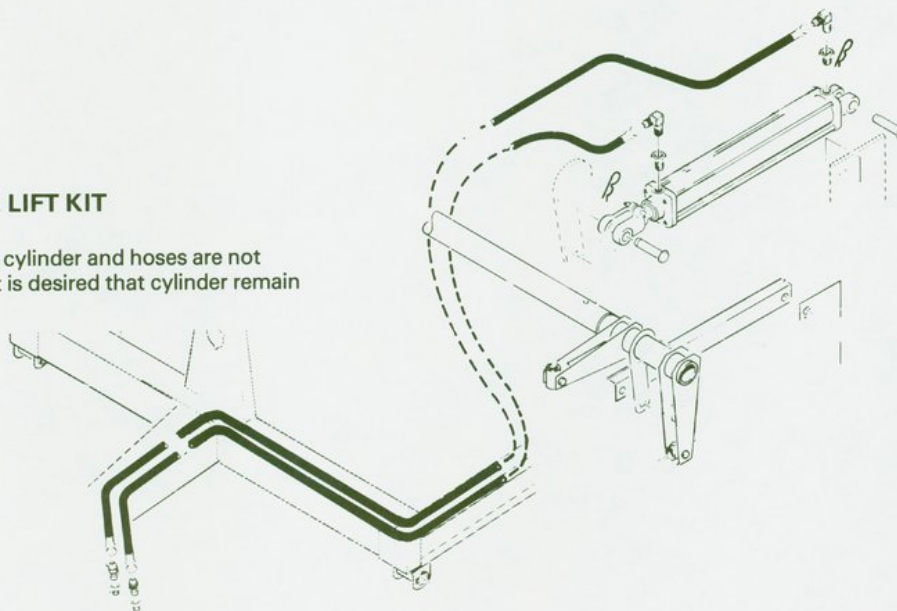

225 POTATO WINDROWER EXTRA EQUIPMENT

Whole Goods
Order Number

965681 12" DIAMETER STRIPPER ROLL KIT

Recommended where vines and trash are heavy.

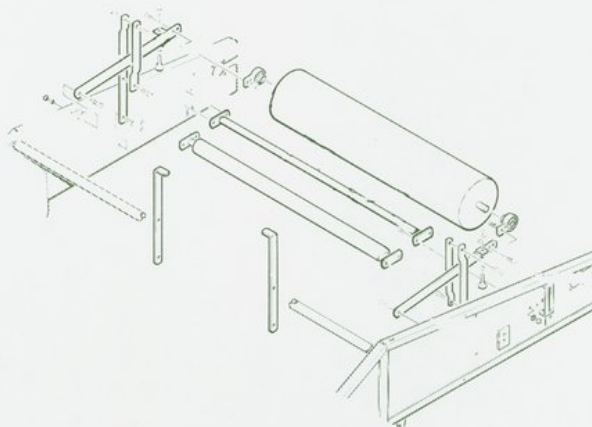

4706-7 WINDROWER COULTER KIT

Recommended where vines and trash are heavy.

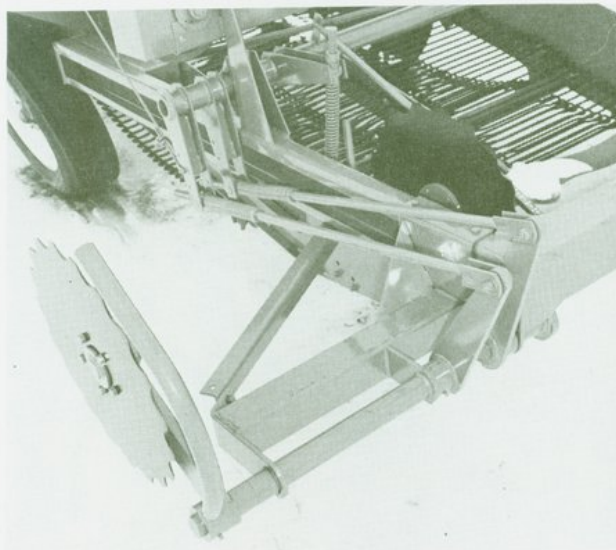

225 POTATO WINDROWER EXTRA EQUIPMENT

Whole Goods
Order Number

965681 12" DIAMETER STRIPPER ROLL KIT

Recommended where vines and trash are heavy.

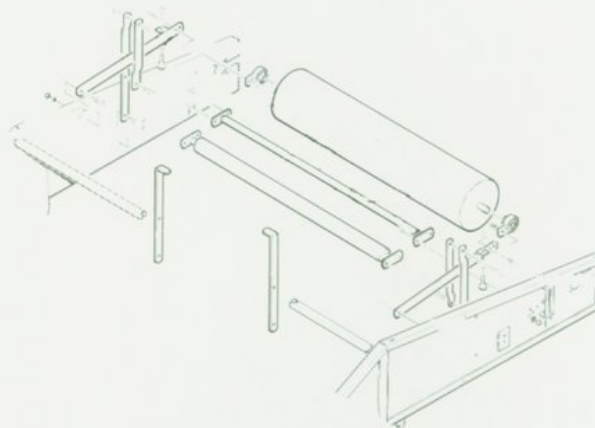

4706-7 WINDROWER COULTER KIT

Recommended where vines and trash are heavy.

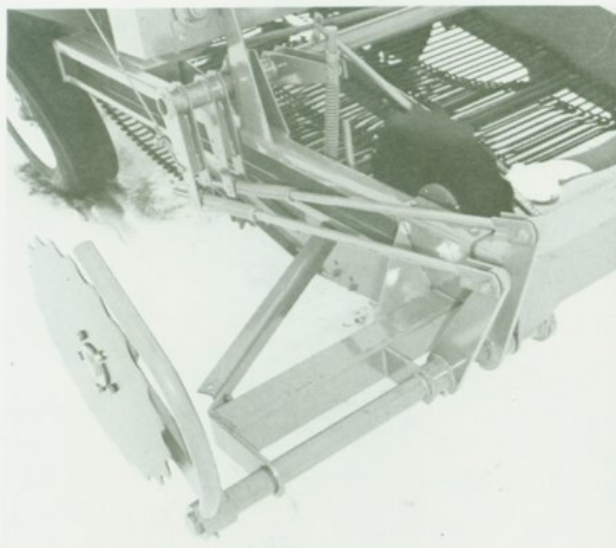

Manure Spreaders



HESSTON MANURE EQUIPMENT

F.O.B. Logan, Utah

LATIN AMERICA

MODEL 1400 MANURE SPREADER

STANDARD EQUIPMENT

| | |
|--|---|
| 1400 gallon, 188 corrosion resistant steel tank, | 10" full length tank auger |
| 25" diameter discharge impeller with rubber paddles | 540 rpm PTO shaft with jaw clutch to protect tand auger |
| 24" wide baffle to reduce longitudinal surge | Clevis type hitch |
| Heavy duty welded frame | Two (2) 7000 lbs. capacity wheels, hubs and spindles |
| Two (2) 21.5 x 16.1 10 ply flotation tires | Impeller driven with RC-80 chain |
| Access steps | Hitch jack |
| Hinged top access door | Pipe vent |
| Hoist hooks at center of tank | Hydraulic discharge gate |
| Swinging 28" diameter hydraulic loader with rubber paddles | Loader position indicator |
| Full tank indicator | Hitch safety chain |

| Order Number | Description | Approx. Weight | List Price | Sugg. Retail |
|--------------|-------------|----------------|------------|--------------|
|--------------|-------------|----------------|------------|--------------|

ONE ITEM FROM EACH BOX MUST BE SPECIFIED

BASE MACHINE

| | | | | |
|------|---------------------------|-----------|--------|-------|
| 4800 | Basic Unit Complete | 3600 lbs. | \$6273 | |
|------|---------------------------|-----------|--------|-------|

Prices Subject to Change Without Notice

Revision 1 35-1

January 1, 1976



HESSTON MANURE EQUIPMENT

F.O.B. Logan, Utah

LATIN AMERICA

MODEL 2000 MANURE SPREADER

STANDARD EQUIPMENT

| | |
|---|---|
| 2000 gallon, .188 corrosion resistant steel tank | Hitch jack |
| 10" two (2) piece tank auger | Hinged top access door |
| 25" diameter discharge impeller with rubber paddles | Pipe vent |
| 540 rpm PTO shaft with clutch to protect tank auger | Hoist hooks |
| Two (2) 24" baffles to reduce longitudinal surge | Hydraulic swinging loader with loading impeller with rubber paddles |
| Clevis type hitch | Impeller driven with RC-80 chain |
| Heavy duty bolt on frame (for shipment) tandem axle walking beam type | Hydraulic cylinders and hose for loading and discharge gates |
| Four (4) 13.5 x 16.1 8 ply tires | Loader position indicator |
| Four (4) 6000 lbs. capacity wheels, hubs and spindles | Hitch safety chain |
| | Break lock out for backing |
| | Full tank indicator |

| Order Number | Description | Approx. Weight | List Price | Sugg. Retail |
|--------------|-------------|----------------|------------|--------------|
|--------------|-------------|----------------|------------|--------------|

ONE ITEM FROM EACH BOX MUST BE SPECIFIED

BASE MACHINE

| | | | |
|------|---------------------------|--------|-------|
| 4801 | Basic Unit Complete | \$8745 | |
|------|---------------------------|--------|-------|

TONGUE OPTIONS

| | | | |
|----|-----------------------------------|---------|-------|
| A1 | Tongue without Brake System | IN BASE | |
| A2 | Tongue with Brake SystemAdd | \$1100 | |

36-1

Prices Subject to Change Without Notice

January 1, 1976

Woods Mowers

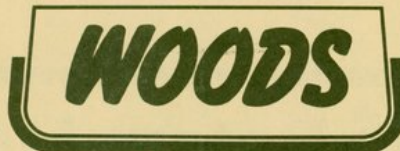

Division of Hesston Corporation

ROTARY MOWERS/FARM IMPLEMENTS PRICE LIST

FOB FACTORY

EFFECTIVE JANUARY 1, 1976

| ● UNDER-MOUNTED ROTARY MOWERS | | Page | ● PULL-TYPE & REAR-MTD ROTARY MOWERS | | Page |
|--|--|------|--|--|------|
| General Information | | 2 | Swath | | |
| For Allis-Chalmers Tractors | | 3 | 6'8" C80 belt-driven, 2 spindle | | 23 |
| " Case " | | 4 | (80") C080 " " (offset) | | 24 |
| " John Deere " | | 5 | 7' 84 "Cadets" regular-duty | | 21 |
| " Ford " | | 6 | R107, heavy-duty | | 22 |
| " Massey-Ferguson " | | 7 | 7½' RM90, rear-mtd lawn mower | | 12 |
| " 1 H " | | 8 | 9' SM2090 gear-driven, 2 spindle (semi-mtd) | | 25 |
| " Imported " (Belarus, Leyland, Deutz, David Brown, Kubota & Satoh) | | 10 | 9½' C114 belt-driven, 3 spindle | | 26 |
| " Universal Mounting | | 11 | 10' 120 gear-driven, 2 spindle | | 27 |
| ● VAC 405 VACUUM COLLECTOR | | 13 | D210R offset Batwing | | 30 |
| ● PULL-TYPE & REAR-MTD ROTARY MOWERS | | Page | 0210 gear-driven, 2 spindle (offset) | | 28 |
| Swath | | | 14' 214 gear-driven, 2 spindle | | 29 |
| 4' M4 "Billy-Goat" | | 14 | SM214 " " (semi-mtd) | | 29 |
| 5' M5, economy model | | 15 | B214 gear-driven, 2 spdl (offset) heavy-duty | | 36 |
| RM59, rear-mtd lawn mower | | 12 | 15' B315 Batwing, 3 spindle, heavy-duty | | 34 |
| 60 "Cadets" regular-duty | | 16 | D315 Batwing, 3 spindle, regular-duty | | 32 |
| R105, heavy-duty | | 17 | 20' B320 Batwing, 3 spindle, heavy-duty | | 36 |
| S105 side-mounted (offset completely) | | 18 | ● HYDRA-BOOST HB 6000 | | 37 |
| 6' 72 "Cadets" regular-duty | | 20 | ● STAK-FEEDER SF 5 | | 37 |
| S106 side-mounted (offset completely) | | 19 | ● BALE FEEDER BF 1500 | | 38 |
| RM306, rear-mtd lawn mower | | 12 | ● REAR SCRAPER BLADE - Light-duty | | 39 |
| | | | - Medium-duty | | 39 |
| | | | - Heavy-duty | | 40 |
| | | | ● BACKHOE T308 | | 41 |

OREGON, ILLINOIS 61061
Ph: (815) 732-6156

Prices Subject to Change Without Notice.

VICKSBURG, MISS. 39181
Ph: (601) 638-2772

Form 2843

WOODS Rotary Mowers

... **Undermounted** --GENERAL INFORMATION ON MOWER USES

Four basic mower models are offered. Each model series is designed for all-purpose mowing, but some models are better suited for specific jobs or mowing conditions.

MODEL 42 SERIES HEAVY-DUTY SINGLE SPINDLE

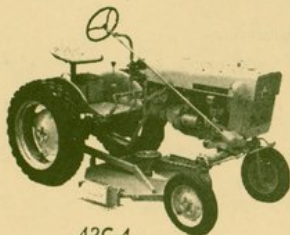

42C-4

CUTS 3-1/2-FT. SWATH
MOWS 2 ACRES PER HOUR

All-purpose mower. Does an excellent job of lawn mowing, high weeds, fence rows & light brush. Equipped with free-swinging, heavy-duty blades and over-running clutch for easier stopping.

Mower cuts to the outside right edge of tractor on smaller tractors, such as IH Cub; does not reach outside of wheel on larger tractors, such as IH "M", "H", Allis-Chalmers "CA", etc.

MODEL 59 CUTS 5-FT. SWATH **MODEL L306** CUTS 6-FT. SWATH

These mowers are designed primarily for lawn mowing. High speed blades are used similar to those on 21" to 24" gas-engine powered lawn mowers. The 59 & L306 are not recommended for mowing high weeds or light brush.

Most Model 59's mow to the outside edge of tractor's right wheel -- the L306 reaches outside right rear wheel on all models.

MODEL 59 & L306 SERIES TRIPLE-BLADE LAWN MOWERS

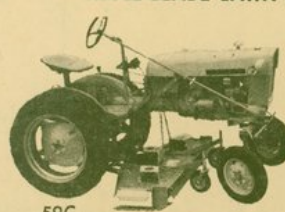

59C

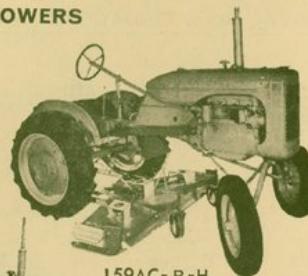

L59AC-B-H

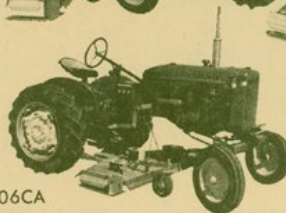

L306CA



UNDER-MOUNTED MOWERS

FOR A-C TRACTORS

| Tractor Make & Model | Description | Model | Weight | Price |
|---|----------------------|------------|--------|----------|
| ALLIS-CHALMERS B with belt pulley (see Note A) | 42" swath, 1 spindle | L42-AC/BH | 288# | \$440.00 |
| & with hydraulic lift, uses tractor cylinder | 60" " , 3 " | L59-AC/BH | 325# | 490.00 |
| | 72" " , 3 " | L306-AC/BH | 435# | 594.00 |
| ALLIS-CHALMERS B with belt pulley (see Note A) | 42" swath, 1 spindle | L42-AC/BM | 290# | 448.00 |
| without hydraulic lift | 60" " , 3 " | L59-AC/BM | 327# | 498.00 |
| | 72" " , 3 " | L306-AC/BM | 437# | 602.00 |
| ALLIS-CHALMERS C with belt pulley (see Note A) | 42" swath, 1 spindle | L42-AC/CH | 297# | 447.00 |
| & with hydraulic lift, uses tractor cylinder | 60" " , 3 " | L59-AC/CH | 334# | 497.00 |
| | 72" " , 3 " | L306-AC/CH | 444# | 601.00 |
| ALLIS-CHALMERS C with belt pulley (see Note A) | 42" swath, 1 spindle | L42-AC/CM | 299# | 455.00 |
| without hydraulic lift | 60" " , 3 " | L59-AC/CM | 336# | 505.00 |
| | 72" " , 3 " | L306-AC/CM | 446# | 609.00 |
| ALLIS-CHALMERS CA with belt pulley (see Note B) | 60" swath, 3 spindle | L59-CA/H | 320# | 485.00 |
| & with hydraulic lift, uses tractor cylinder | 72" " , 3 " | L306-CA/H | 427# | 595.00 |
| ALLIS-CHALMERS D10 or D12 with hydraulic lift, uses tractor rear rockshaft (for D14, see Accessories below) | 60" swath, 3 spindle | L59-D10/H | 378# | 594.00 |
| | 72" " , 3 " | L306-D10/H | 481# | 679.00 |
| ALLIS-CHALMERS G | 42" swath, 1 spindle | 42-G | 268# | 428.00 |
| ALLIS-CHALMERS WD & WD 45, uses rear rockshaft for lift | 60" swath, 3 spindle | L59-AC/WD | 426# | 563.00 |
| | 72" " , 3 " | L306-AC/WD | 536# | 624.00 |

| Part # | Used On | Accessories | | |
|--------|----------|---|---|-------------|
| 18422 | L59 | Casters: Pair of casters (1 left & 1 right) | 24# | \$ 56.00 |
| 24095 | L306 | Casters: Bundle of two (2 - #13400) casters | 37# | 81.00 |
| 3605 | 42 | Leaf Mulcher | 54# | 104.00 |
| 7080 | L59 | " " " " | 56# | 96.00 |
| 13482 | L306 | " " " " | 68# | 104.00 |
| 9122 | L59 | AC D14 Mounting Kit: order this kit in addition to L59-D10/H or L306-D10/H to fit A-C D14 | 14# | 21.00 |
| 24650 | L59&L306 | Front roller complete | 10# | 30.00 |
| Part # | No. Req. | Used On | EXTRA BLADES | |
| 3975 | 2 | 42 | Medium suction blade (standard) | 4# 9.50 ea |
| 12064 | 2 | " | Welded-fin type, high suction and shredding | 5# 10.50 ea |
| 3980 | 2 | L42 | Medium suction blade (standard) | 4# 9.50 ea |
| 12065 | 2 | " | Welded - fin type, high suction and shredding | 5# 10.50 ea |
| 23825 | 3 | L59 | Medium suction blade (standard) | 3# 6.75 ea |
| 25997 | 3 | " | Low suction for blade reduced wear in abrasive soil | 3# 6.75 ea |
| 12091 | 3 | " | Welded-fin type, high suction and shredding | 3½# 9.25 ea |
| 13404 | 3 | L306 | Formed, suction blade (standard) | 4# 7.75 ea |
| 18740 | 3 | " | Welded-fin type, high suction and shredding | 4½# 9.50 ea |

COMPONENTS FOR ABOVE MOWERS

| Model No. | Frames | | | | | | | | | | Boxes, Bundles, Brackets, etc. | | | | | | | | | |
|------------|--------|-------|-------|-------|-------|-------|------|-------|-------|-------|--------------------------------|-------|-------|-------|------|------|------|------|------|-------|
| | 9031 | 9026 | 9701 | 9702 | 9377 | 9703 | 9181 | 9704 | 9705 | 9706 | 3612 | 9707 | 9709 | 9708 | 7442 | 9376 | 9201 | 9039 | 9421 | 9710 |
| L42-AC/BH | \$134 | \$134 | \$263 | \$349 | \$221 | \$191 | \$96 | \$166 | \$142 | \$160 | \$294 | \$155 | \$331 | \$179 | \$25 | \$60 | \$67 | \$33 | \$13 | \$330 |
| L42-AC/BM | 126# | 128# | 183# | 278# | 110# | 150# | 78# | 165# | 90# | 105# | 140# | 88# | 195# | 100# | 12# | 40# | 49# | 14# | 15# | 203# |
| L42-AC/CH | | | | | | | | | | | | | | | | | | | | |
| L42-AC/CM | | | | | | | | | | | | | | | | | | | | |
| 42-G | | | | | | | | | | | | | | | | | | | | |
| L59-AC/BH | | | | | | | | | | | | | | | | | | | | |
| L59-AC/BM | | | | | | | | | | | | | | | | | | | | |
| L59-AC/CH | | | | | | | | | | | | | | | | | | | | |
| L59-AC/CM | | | | | | | | | | | | | | | | | | | | |
| L59-AC/WD | | | | | | | | | | | | | | | | | | | | |
| L59-CA/H | | | | | | | | | | | | | | | | | | | | |
| L59-D10/H | | | | | | | | | | | | | | | | | | | | |
| L306-AC/BH | | | | | | | | | | | | | | | | | | | | |
| L306-AC/BM | | | | | | | | | | | | | | | | | | | | |
| L306-AC/CH | | | | | | | | | | | | | | | | | | | | |
| L306-AC/CM | | | | | | | | | | | | | | | | | | | | |
| L306-AC/WD | | | | | | | | | | | | | | | | | | | | |
| L306-CA/H | | | | | | | | | | | | | | | | | | | | |
| L306-D10/H | | | | | | | | | | | | | | | | | | | | |

Note A: AC tractors B & C manufactured before 1939 have a smaller, tapered belt pulley shaft. Replace it with AC 208959 or build up with shims or by welding. (These models will not fit Model 1B)

Note B: If tractor is equipped with snap coupler drawbar, complete drawbar must be removed. Optional AC drawbar channel #225150 & brace #225148 (2 required) may be substituted.



UNDER-MOUNTED MOWERS

FOR JOHN DEERE TRACTORS

| Tractor Make & Model | Description | Model | Weight | Price |
|--|-------------------------------------|-----------------------|--------------|--------------------|
| JOHN DEERE M, MS, 40S, 320S, 330S, 420S, 430S, with PTO; lower 3-pt . . . hitch arms must be removed (also see Note A below) | 60" swath, 3 spindle 72" " , 3 " | L59-JM/H L306-JM/H | 355# 459# | \$551.00 651.00 |
| JOHN DEERE B or A, 30T, 40T, 320T, 420T, 330T, 430T, etc. (34" minimum wheel size) | 60" swath, 3 spindle 72" " , " | L59-U/M* L306-U/M* | 445# 555# | 610.00 671.00 |

NOTE: For other John Deere mountings, see Page 11.

| Part # | Used On | ACCESSORIES | | |
|--------|------------|---|-----|----------|
| 18422 | L59 | Casters: Pair of casters (1 left & 1 right) (not for tractors with swept-back front axle or where tire clearance is limited, such as JD 1010, 1020, etc.) | 24# | \$ 56.00 |
| 24095 | L306 | Casters: Bundle of 2 (2-#13400) casters (Restriction on caster use also applies as noted for L59 above) | 37# | 81.00 |
| 3605 | L42 | Leaf Mulcher | 54# | 104.00 |
| 7080 | L59 | Leaf Mulcher | 56# | 96.00 |
| 13482 | L306 | Leaf Mulcher | 68# | 104.00 |
| 24650 | L59 & L306 | Front Roller Complete | 10# | 30.00 |

| Part # | No Req | Used On | EXTRA BLADES | | |
|--------|--------|---------|--|-----|----------|
| 3980 | 2 | L42 | Medium suction blade (standard) | 4# | 9.50 ea |
| 12065 | 2 | " | Welded fin type, high suction and shredding | 5# | 10.50 ea |
| 23825 | 3 | L59 | Medium suction blade (standard) | 3# | 6.75 ea |
| 25997 | 3 | " | Low suction blade for reduced wear in abrasive soil. . . | 3# | 6.75 ea |
| 12091 | 3 | " | Welded-fin type, high suction and shredding | 3½# | 9.25 ea |
| 13404 | 3 | L306 | Medium suction blade (standard) | 4# | 7.75 ea |
| 18740 | 3 | " | Welded-fin type, high suction and shredding | 4½# | 9.50 ea |

COMPONENTS FOR ABOVE MOWERS

| Model No. | Frames | | Boxes, Bundles, Brackets, etc. | | | | | | | |
|-----------|--------|-------|--------------------------------|------|------|------|-------|-------|-------|-------|
| | 9701 | 9702 | 9058 | 9039 | 9170 | 9181 | 9713 | 9703 | 9714 | 9704 |
| | \$263 | \$349 | \$78 | \$33 | \$27 | \$96 | \$210 | \$191 | \$224 | \$166 |
| | 183# | 278# | 52# | 14# | 20# | 78# | 120# | 150# | 129# | 165# |
| L59-JM/H | " | " | " | " | " | " | " | " | " | " |
| L59-U/M | " | " | " | " | " | " | " | " | " | " |
| L306-JM/H | " | " | " | " | " | " | " | " | " | " |
| L306-U/M | " | " | " | " | " | " | " | " | " | " |

Note A: Also fits 40U, 40W, 320U, 330U, 420U, 430U, & 440U, but final drive housings must be turned downward for ground clearance. Short PTO assembly must be used. On the 40U, use short PTO (usually standard) JD #AM2185 before Serial No. 65209; #AM2547T after Serial No. 65209.

*Model numbers having "U" following the number, such as L59-U/M, use a universal mounting which can be used with a variety of tractors. Tractors must have 15" ground clearance below differential housing and meet other specifications. See explanation on Page 11.

UNDER-MOUNTED MOWERS

NOTE: For tractors not listed, see Universal models, Page 11.

● FOR SHIPPING COMPONENTS & EXTRA BLADES, SEE PAGE 9

- (a) Model numbers having a "U" following the number, such as L59-U, use a universal mounting which can be used with a variety of tractors. See explanation on page 11.
- (b) For L42 & L306, also order Lift Bracket #3663 (\$4, 2#).
- (c) For L306-U only, also order Manual Lift Bundles #9039 & #9045 (\$45, 22# for both).
- (d) If tractor has Fast Hitch, it must be removed.
- (e) For 44-LB when tractor is equipped with 13.6-16 Terra tires, use IH wheel spacer kit.

Hesston sales manual

UNDER-MOUNTED MOWERS

FOR IH TRACTORS

● EXTRA BLADES FOR 42, 59 & L306 SERIES MOWERS

(continued)

| Part# | No. Req. | Used On | Description | Weight | Price |
|-------|----------|------------|---|--------|------------|
| 3975 | 2 | 42's, 44's | Medium suction blade (standard) | 4# | \$ 9.50 ea |
| 12064 | 2 | " " | Welded fin type, high suction and shredding | 5# | 10.50 ea |
| 3980 | 2 | L42's | Medium suction blade (standard) | 4# | 9.50 ea |
| 12065 | 2 | " " | Welded fin type, high suction and shredding | 5# | 10.50 ea |
| 6950 | 3 | 59's | Medium suction blade (standard) | 3# | 6.75 ea |
| 12090 | 3 | " " | Welded fin type, high suction and shredding | 3½# | 9.25 ea |
| 23825 | 3 | L59's | Medium suction blade (standard) | 3# | 6.75 ea |
| 12091 | 3 | " " | Welded fin type, high suction and shredding | 3½# | 9.25 ea |
| 25997 | 3 | " " | Low suction blade for reduced wear in abrasive soil | 3# | 6.75 ea |
| 13404 | 3 | L306's | Medium suction blade (standard) | 4# | 7.75 ea |
| 18740 | 3 | " " | Welded fin type, high suction and shredding | 4½# | 9.50 ea |

● SHIPPING COMPONENTS OF MOWERS LISTED ON FACING PAGE

| Model No. | Frames | | | | Boxes, Bundles, Brackets, etc. | | | | | | | | | |
|-----------|--------|-------|-------|-------|--------------------------------|-------|-------|-------|-------|-------|-------|-------|-------|-------|
| | 9026 | 9031 | 9444 | 9032 | 9033 | 9034 | 9039 | 9044 | 9045 | 9238 | 9241 | 9324 | 9422 | 9443 |
| | \$134 | \$134 | \$134 | \$231 | \$262 | \$388 | \$ 33 | \$263 | \$ 12 | \$ 54 | \$262 | \$ 13 | \$ 26 | \$247 |
| | 128# | 126# | 142# | 140# | 122# | 132# | 14# | 133# | 8# | 48# | 102# | 9# | 46# | 93# |
| 42-C/H | " | " | " | " | " | " | " | " | " | " | " | " | " | " |
| 42-C/M | " | " | " | " | " | " | " | " | " | " | " | " | " | " |
| 42-CF/H | " | " | " | " | " | " | " | " | " | " | " | " | " | " |
| 42-CL/H | " | " | " | " | " | " | " | " | " | " | " | " | " | " |
| 42-HB/M | " | " | " | " | " | " | " | " | " | " | " | " | " | " |
| L42-A/H | " | " | " | " | " | " | " | " | " | " | " | " | " | " |
| L42-A/M | " | " | " | " | " | " | " | " | " | " | " | " | " | " |
| 44-LB | " | " | " | " | " | " | " | " | " | " | " | " | " | " |

| Model No. | Frames | | | | Boxes, Bundles, Brackets, etc. | | | | | | | | | | | | | | | | | | |
|--------------|---------------|---------------|---------------|------------|--------------------------------|---------------|--------------|-------------|---------------|---------------|------------|-------------|-------------|---------------|-------------|---------------|-------------|--------------|---------------|------------|-------------|--------------|---------------|
| | 9700 | 9701 | 9702 | 8150 | 9719 | 9720 | 9721 | 9039 | 9722 | 9723 | 9045 | 9170 | 9171 | 9703 | 9181 | 9704 | 9238 | 9724 | 9725 | 9324 | 9422 | 9416 | 9735 |
| | \$263 183# | \$263 183# | \$349 278# | \$42 7# | \$172 135# | \$332 123# | \$169 97# | \$33 14# | \$174 112# | \$192 118# | \$12 8# | \$27 20# | \$40 10# | \$191 150# | \$96 78# | \$166 165# | \$54 48# | \$168 90# | \$156 100# | \$13 9# | \$26 46# | \$117 68# | \$335 189# |
| 59-C/H | " | " | " | " | " | " | " | " | " | " | " | " | " | " | " | " | " | " | " | " | " | " | " |
| 59-C/M | " | " | " | " | " | " | " | " | " | " | " | " | " | " | " | " | " | " | " | " | " | " | " |
| 59-CF/H | " | " | " | " | " | " | " | " | " | " | " | " | " | " | " | " | " | " | " | " | " | " | " |
| 59-CL/H | " | " | " | " | " | " | " | " | " | " | " | " | " | " | " | " | " | " | " | " | " | " | " |
| 59-HB/M | " | " | " | " | " | " | " | " | " | " | " | " | " | " | " | " | " | " | " | " | " | " | " |
| 59-HC/H | " | " | " | " | " | " | " | " | " | " | " | " | " | " | " | " | " | " | " | " | " | " | " |
| 59-HC/M | " | " | " | " | " | " | " | " | " | " | " | " | " | " | " | " | " | " | " | " | " | " | " |
| 59-LB | " | " | " | " | " | " | " | " | " | " | " | " | " | " | " | " | " | " | " | " | " | " | " |
| L59-A/H | " | " | " | " | " | " | " | " | " | " | " | " | " | " | " | " | " | " | " | " | " | " | " |
| L59-A/M | " | " | " | " | " | " | " | " | " | " | " | " | " | " | " | " | " | " | " | " | " | " | " |
| L59-U | " | " | " | " | " | " | " | " | " | " | " | " | " | " | " | " | " | " | " | " | " | " | " |
| L59-U/H | " | " | " | " | " | " | " | " | " | " | " | " | " | " | " | " | " | " | " | " | " | " | " |
| L59-U/M | " | " | " | " | " | " | " | " | " | " | " | " | " | " | " | " | " | " | " | " | " | " | " |
| L306-A/H | " | " | " | " | " | " | " | " | " | " | " | " | " | " | " | " | " | " | " | " | " | " | " |
| L306-A/M | " | " | " | " | " | " | " | " | " | " | " | " | " | " | " | " | " | " | " | " | " | " | " |
| L306-H3 | " | " | " | " | " | " | " | " | " | " | " | " | " | " | " | " | " | " | " | " | " | " | " |
| L306-U | " | " | " | " | " | " | " | " | " | " | " | " | " | " | " | " | " | " | " | " | " | " | " |
| L306-U/H | " | " | " | " | " | " | " | " | " | " | " | " | " | " | " | " | " | " | " | " | " | " | " |
| L306-U/M | " | " | " | " | " | " | " | " | " | " | " | " | " | " | " | " | " | " | " | " | " | " | " |



FOR IMPORTED TRACTORS

UNDER-MOUNTED MOWERS

| Tractor Make & Model | Description | Model | Weight | Price |
|---|--|-------------------------------------|----------------------|----------------------------|
| BELARUS T250 & T250A when equipped with 3-point lift and 540 rpm PTO | 42" swath, 1 spindle 72" swath, 3 spindle | L42-B25 L306-B25 | 334# 471# | \$ 517.00 679.00 |
| LEYLAND 154 (BMC 4/25 & Long 4/25) when equipped with 2-speed PTO, 3-point lift (Casters extra) | 60" swath, 3 spindle 72" swath, 3 spindle | L59-BMC L306-BMC | 319# 428# | 499.00 605.00 |
| DAVID BROWN 780, 880, 885, 3800, 4506 & 4600 when equipped with w/multi-speed PTO, 3-pt lift & sway bars. Uses 1000rpm PTO (Casters extra) | 72" swath, 3 spindle | L306-DB | 423# | 644.00 |
| DEUTZ 2506, 3006, 4006 & 4506 when equipped with 540 rpm PTO & 3-pt lift (Casters extra for 4006 & 4506; cannot mount on 2506 & 3006). | 60" swath, 3 spindle 72" swath, 3 spindle | L59-D L306-D | 403# 501# | 537.00 630.00 |
| KUBOTA All Kubota's, except B6000, must be equipped with PTO & 3-pt lift. (Complete 3-pt lift may be left on tractor). Casters are optional. | | | | |
| L175 | 60" swath, 3 spindle | L59-K17 | 314# | 492.00 |
| L225 | 60" swath, 3 spindle 72" swath, 3 spindle | L59-K17 L306-K22 (c) | 314# 419# | 492.00 633.00 |
| L200 & L210 | 42" swath, 1 spindle 60" swath, 3 spindle 72" swath, 3 spindle | L44-KL (a) L59-K210 L306-K210 | 300# 321# 446# | 446.00 490.00 635.00 |
| L260 | 42" swath, 1 spindle 60" swath, 3 spindle 72" swath, 3 spindle | L44-KL (a) L59-K260 L306-K260 | 300# 322# 447# | 446.00 490.00 635.00 |
| B6000 (For 2-wheel drive tractors only) when equipped with front electric clutch & 3-point lift | 48" swath, 3 spindle | 304-K(b) | 208# | 430.00 |
| SATOH | | | | |
| S550G (when equipped with 3-pt lift & 540 rpm PTO) Lower 3-point arms must be removed. Casters are optional | 60" swath, 3 spindle | L59-S55 | 348# | 530.00 |
| S650 & S650G Must be 3-pt hitch equipped w/multi-speed PTO. (Uses high speed PTO) Caster are standard equipment on L59-S and optional on L306-S | 60" swath, 3 spindle 72" swath, 3 spindle | L59-S L306-S | 331# 428# | 538.00 659.00 |
| ● ACCESSORIES | | | | |
| Part # Used On | | | | |
| 18422 L59 | Casters: Pair of casters (1 left & 1 right) (for BMC & Deutz only) | | | |
| 23905 L59-K17, K210 | Casters: special short side-mounted required for Kubota L175, L200, L225, L210, L260 & Satoh S550G tractors; bundle of 2 | | | |
| 24095 L306 | Casters: Bundle of 2 (2-#13400) (for Belarus, BMC, David Brown, Kubota and Deutz 4006 & 4506 only) | | | |
| 3605 L44 | Leaf Mulcher | | | |
| 7080 L59 | " " | | | |
| 13482 L306 | " " | | | |
| 24650 L59 & L306 | Front Roller Complete | | | |
| 24255 L306-K22 | Belt Take Up Shield for Kubota L225 equipped with ag tires | | | |
| ● EXTRA BLADES | | | | |
| Part # Req Used On | | | | |
| 3980 2 L44 | Medium suction blade (standard) | | | |
| 12065 2 " | Welded fin type, high suction and shredding | | | |
| 23825 3 L59 | Medium suction blade (standard) | | | |
| 25997 3 " | Low suction blade for reduced wear in abrasive soil | | | |
| 12091 3 " | Welded fin type, high suction and shredding | | | |
| 13404 3 L306 | Medium suction blade (standard) | | | |
| 18740 3 " | Welded fin type, high suction and shredding | | | |
| 12170 3 304-K | Medium suction blade (standard) | | | |

● COMPONENTS FOR ABOVE MOWERS

| Model No. | Frames | Idlr Brkts | Boxes, Bundles, Kits, Etc. |
|-----------|--------|------------|----------------------------|
| 9031 | 9444 | 9701 | 9702 |
| 9181 | 9411 | 9732 | 9736 |
| 9726 | 9412 | 9727 | 9428 |
| 9470 | 9729 | 9728 | 9631 |
| 9630 | 9730 | 9575 | 9576 |
| 9577 | 9731 | 9579 | 9580 |
| 9659 | 9734 | 9733 | |
| 9733 | | | |
| 126# | 142# | 183# | 278# |
| 78# | 48# | 53# | 145# |
| 95# | 88# | 102# | 148# |
| 158# | 145# | 142# | 46# |
| 85# | 150# | 125# | 13# |
| 14# | 152# | 16# | 17# |
| 165# | 155# | 140# | |
| L42-B25 | " | " | " |
| L44-KL | " | " | " |
| L59-BMC | " | " | " |
| L59-D | " | " | " |
| L59-K17 | " | " | " |
| L59-K210 | " | " | " |
| L59-K260 | " | " | " |
| L59-S55 | " | " | " |
| L59-S | " | " | " |
| L306-BMC | " | " | " |
| L306-D | " | " | " |
| L306-DB | " | " | " |
| L306-K22 | " | " | " |
| L306-K210 | " | " | " |
| L306-K260 | " | " | " |
| L306-S | " | " | " |
| L306-B25 | " | " | " |

- (a) The L44-KL does not mow outside of tractor tires. Right front & rear tractor wheels must be moved out to clear mower frame.
 (b) 304-K shipped as one component, #9605.
 (c) For Kubota L225 equipped with ag tires, also order belt take up shield #24255.