

By the President of the United States, a proclamation: whereas it appears that the public good will be promoted by eliminating certain lands within the State of Kansas from the Kansas National Forest

This proclamation by President William H. Taft changes the boundaries of the Kansas National Forest. The original forest boundaries are illustrated on the diagram from the U.S. Department of Agriculture Forest Service. The forest was located west of Garden City and south of the Atchison, Topeka, and Sante Fe Railroad in Finney, Haskell, Grant, Kearny, and Hamilton counties. The proclamation excludes land west of Syracuse, Kansas and east of the Colorado border.

Creator: Taft, William Howard, 1857-1930

Date: February 24, 1913

Callnumber: K 634.9 Mss. No.2

KSHS Identifier: DaRT ID: 310961

Item Identifier: 310961

www.kansasmemory.org/item/310961

KANSAS
HISTORICAL
SOCIETY

By the President of the United States, a proclamation: whereas it appears that the public good will be promoted by eliminating certain lands within the State of Kansas from the Kansas National Forest

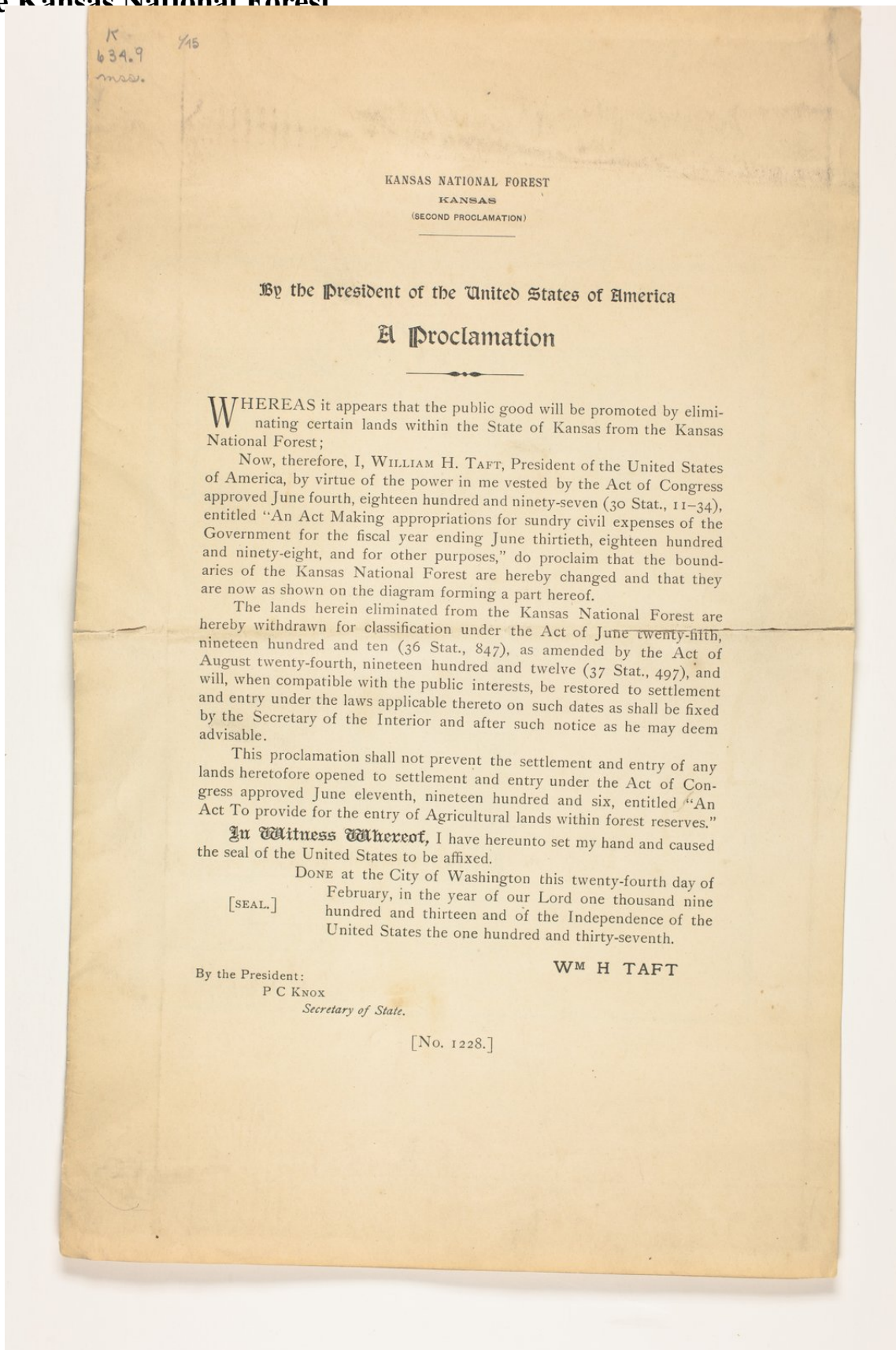

By the President of the United States, a proclamation: whereas it appears that the public good will be promoted by eliminating certain lands within the State of Kansas from the Kansas National Forest

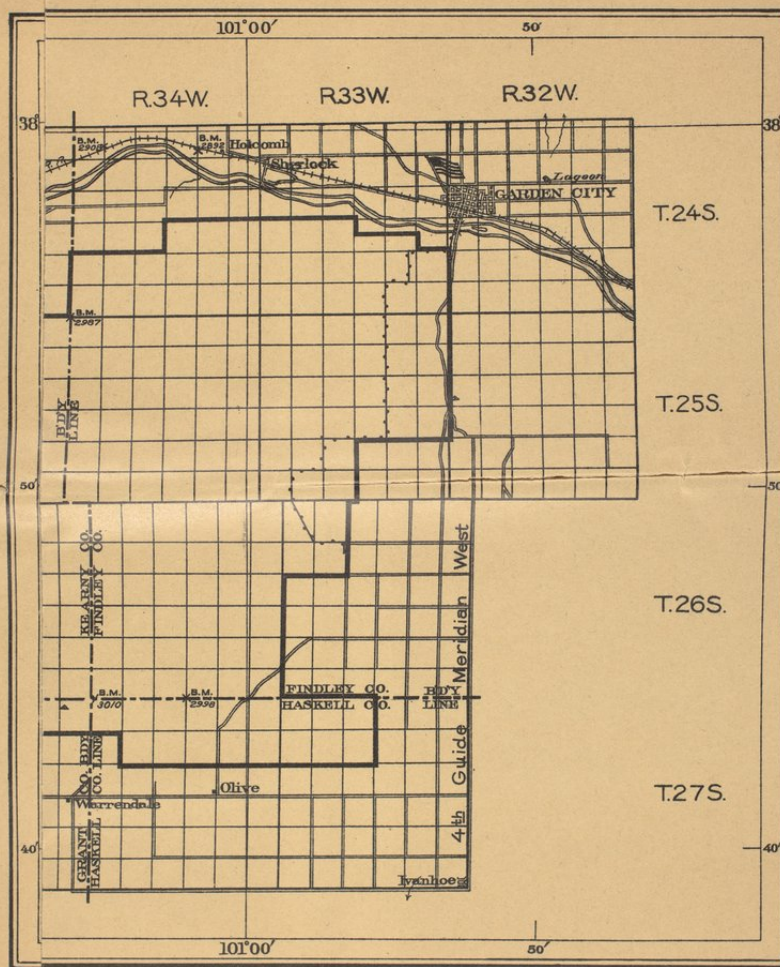

By the President of the United States, a proclamation: whereas it appears that the public good will be promoted by eliminating certain lands within the State of Kansas from the Kansas National Forest

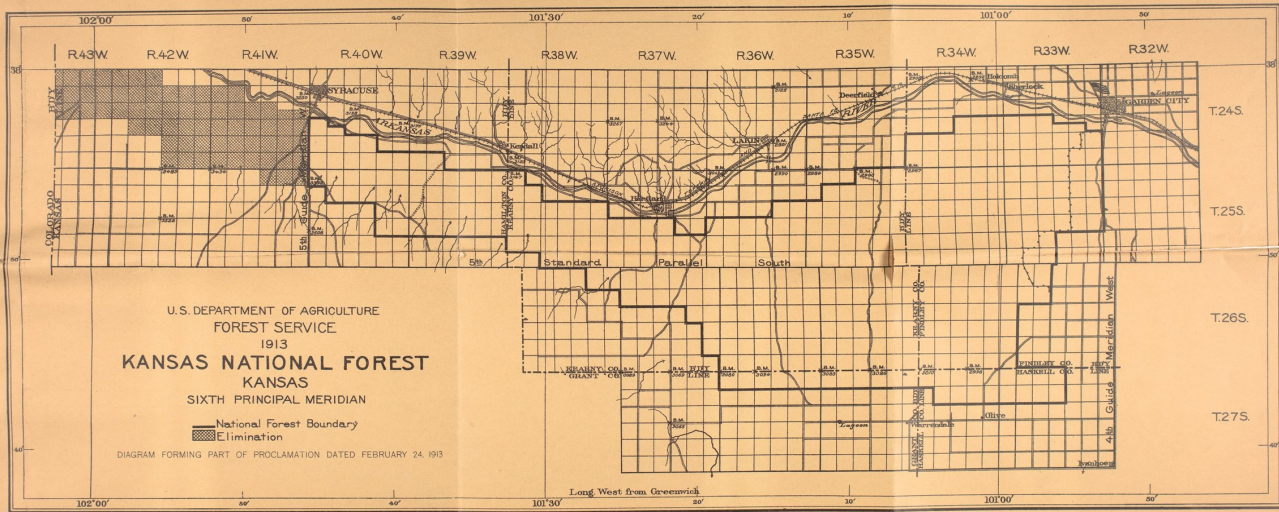

By the President of the United States, a proclamation: whereas it appears that the public good will be promoted by eliminating certain lands within the State of Kansas from the Kansas National Forest

